

TYPICAL FLOORPLAN

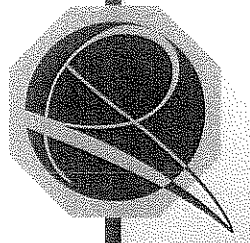

THE ATRIUM
ON RINGLING

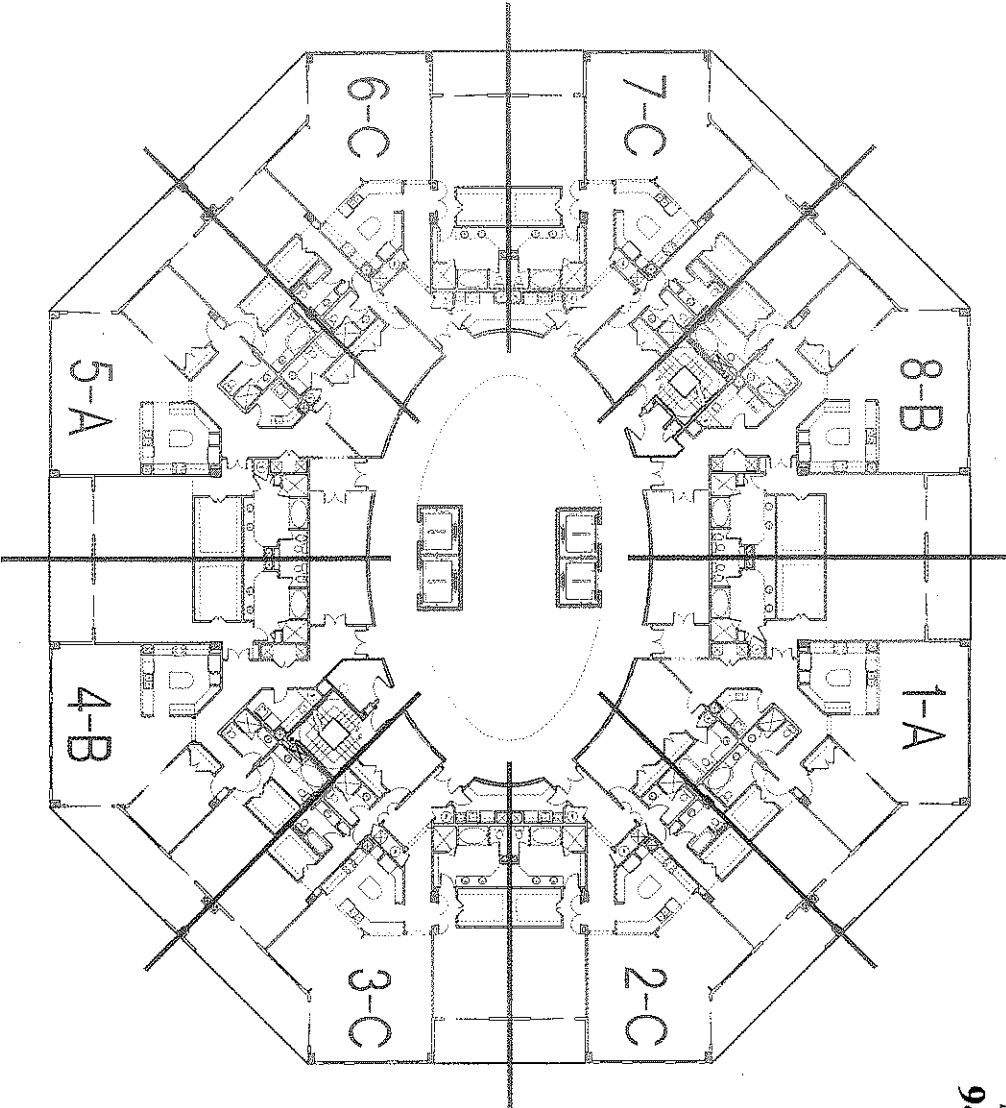

Provided by:



Candy Swick & Company

Licensed Real Estate Broker

941-954-9000

All dimensions are approximate. The floorplan is subject to change. The developer reserves the absolute right, in the sole judgment and discretion, to substitute appliances, materials, fixtures and equipment of equal or greater value for those specified. Oral representations cannot be relied upon as contract. For correct representations, make reference to this brochure and to the documents required by section 7-25.03. Foster Shingles to be furnished by a decorator to a buyer or lessee. Prices, plans and specifications subject to change without notice. Offer valid while published by law. Broker cooperation welcome. An independently owned and operated member of The Prudential Real Estate Affiliates, Inc. Prudential is a service mark of The Prudential Insurance Company of America.